



INTERNAL DIMENSIONS: 29" X 16 11/16" (736.6 mm x 423.8625 mm)

DEPTH: 9" (228.6 mm)

Depth does not include countertop thickness

The Bellavati™ K2917 is Doyle Farris' newest design. With tighter radii, sleek curves, steeper side walls, and narrower sink divider offers more usable floor space at the bottom of the sink than other models. This sink is reversible so the small sink can be on the left or right. The lowered divider bar offers an aesthetic improvement to the sink as well as easier routing and sanding for the fabricator. This European style double equal kitchen sink provides a seamless kitchen sink in any solid surface sheet material, acrylic, polyester or blended. This sink fits well in a 36" cabinet.

Bellavati™ Sinks are compatible and warranted when used with all major solid surface sheet brands with the same sheet warranties.

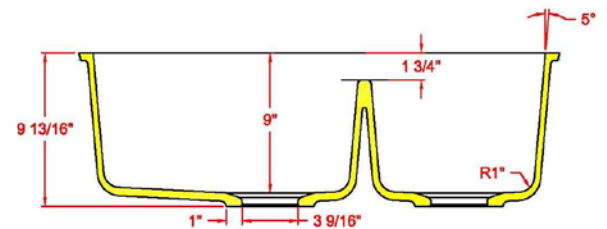
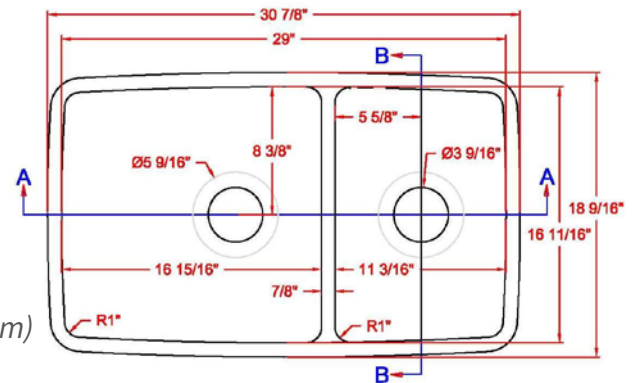

Section A-A

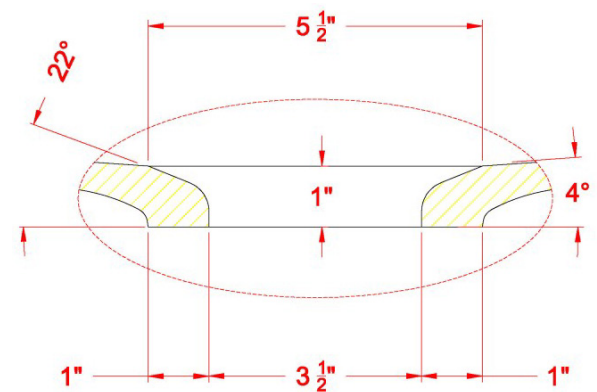

Drain Detail



UL in the US and Canada:
(ANSI Z124.6 & B45.0-99)



NAHB) : HB (ANSI Z124.6)



All Bellavati™ sinks use resin containing 15% post consumer recycled content and 5.5% rapidly renewable materials.



All Bellavati™ sinks are proudly made in the USA.

DOYLE  FARRIS

3030 North Rocky Point Drive West • #150 • Tampa • Florida • 33607 • 877-264-1499

sales@doylefarris.com • www.doylefarris.com